



**ITM**

# HEAVY METAL

UPPER Bi-Metal • USA

8% CO-18T



STEEL PIPE

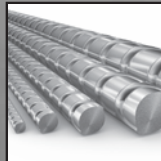

REBAR



I-BEAM



STAINLESS & STEEL PLATE





# HEAVY METAL

## 8% Co - SUPER Bi-Metal



### HEAVY METAL RECIPROCATING BLADES

- 1" Width
- 0.042" Thickness
- Greater Rigidity
- Blunt Nose
- **Made in USA**



STEEL PIPE

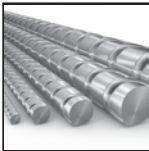

REBAR

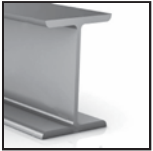

I-BEAM

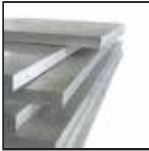

STAINLESS & STEEL PLATE

Part #	Description	Thickness	Pack QTY.	UOM	List
HM610	6" X 10T HEAVY-METAL	0.042"	5	EA	\$4.29
HM614	6" X 14T HEAVY-METAL	0.042"	5	EA	\$4.29
HM618	6" X 18T HEAVY-METAL	0.042"	5	EA	\$4.29
HM910	9" X 10T HEAVY-METAL	0.042"	5	EA	\$5.74
HM914	9" X 14T HEAVY-METAL	0.042"	5	EA	\$5.74
HM918	9" X 18T HEAVY-METAL	0.042"	5	EA	\$5.74
HM1214	12" X 14T HEAVY-METAL	0.042"	5	EA	\$6.84
HM1218	12" X 18T HEAVY-METAL	0.042"	5	EA	\$6.84

BU-HM610	6" X 10T HEAVY-METAL	0.042"	50	EA	\$4.02
BU-HM614	6" X 14T HEAVY-METAL	0.042"	50	EA	\$4.02
BU-HM618	6" X 18T HEAVY-METAL	0.042"	50	EA	\$4.02
BU-HM910	9" X 10T HEAVY-METAL	0.042"	50	EA	\$5.47
BU-HM914	9" X 14T HEAVY-METAL	0.042"	50	EA	\$5.47
BU-HM918	9" X 18T HEAVY-METAL	0.042"	50	EA	\$5.47
BU-HM1214	12" X 14T HEAVY-METAL	0.042"	50	EA	\$6.57
BU-HM1218	12" X 18T HEAVY-METAL	0.042"	50	EA	\$6.57

